

## 12 x 6,5" + 4 x 15" 3-Way Line-Array Front-System

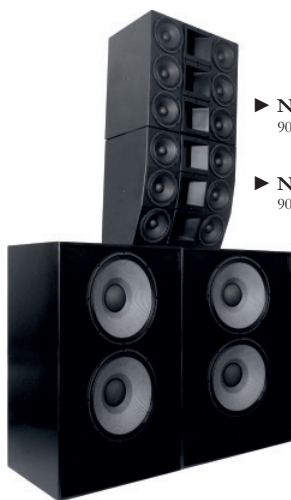

▶ **NCS L63F = Flat Version**  
90° x 15° dispersion (HxV)

▶ **NCS L63C = Curved Version**  
90° x 36° dispersion (HxV)

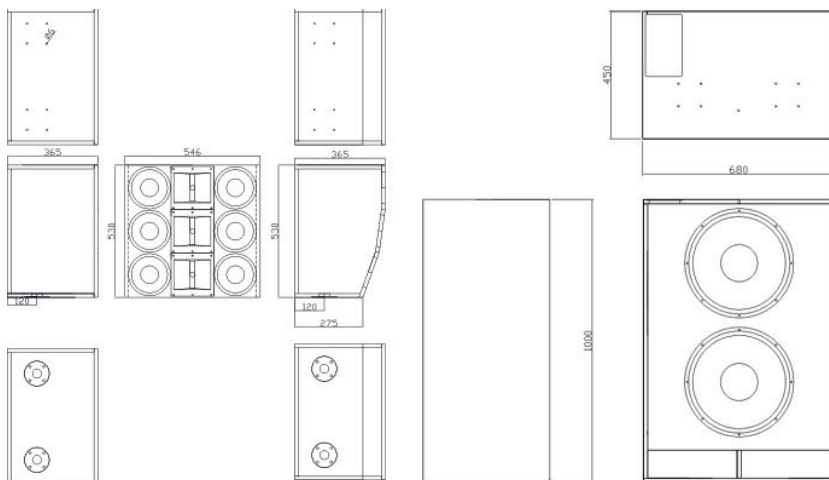

### Features NCS L63F (flat version) Line Array

- ▶ 720 W / 1.440 W power handling
- ▶ 90° x 15° (curved) dispersion (HxV)
- ▶ Vertical array design
- ▶ Very high SPL

### Features NCS L63C (curved version) Line Array

- ▶ 720 W / 1.440 W power handling
- ▶ 90° x 36° (curved) dispersion (HxV)
- ▶ Vertical array design
- ▶ Very high SPL

### 2 x NCS 215B Subwoofer

- ▶ 1.200 W / 2.400 W power handling
- ▶ 2 x 15" high power loudspeaker
- ▶ 4" voice coil
- ▶ Very low power compression
- ▶ Integrated voice coil cooling system
- ▶ TML cabinet design
- ▶ Deep and clear bass reproduction

### NCS L63F / NCS L63C Line Array

The NCS L63 F/C is a two-way high performance screen channel loudspeaker system. The cabinet is equipped with three 1" HF drivers (1.75" voice coil), which are mounted onto an vertical array horn design. The NCL L63 F/C is available in two versions with different vertical angles. The nominal coverage of the F version is 90° x 15° (H x V). The C version has a coverage of 90° x 36° (H x V). The MF/LF frequency range is covered by six 120 Watts 6,5" speaker which are mounted in a non vented cabinet to ensure very clear and low / mid reproduction. The system can be driven in active or passive mode. Therefore a passive crossover is available. The cabinet is constructed by 15mm wood, covered with Black NOVA PolyCoat® finish and equipped with several M6 and M8 screws and two 35mm speaker stand adapter which ensures the safe and stable connection to the optional accessories. Four open end sockets are mounted on the back of the cabinet for signal input and link output. The power rating of the NCS L63 F/C is 720W at 5.4 Ohms

### NCS 215B Subwoofer

The NCS 215 B is a high performance screen channel bass system. The Sub frequency range is covered by two 600 Watts 15" speakers which are mounted in a perfect tuned TML design to ensure clear and deep bass reproduction. The system can be driven in active mode. The recommended crossover frequency is between 80 and 120 Hz. The cabinet is constructed by 15mm wood, covered with Black NOVA PolyCoat® finish and equipped with several M6 and M8 screws which ensures the safe and stable connection to the optional accessories. Four open end sockets are mounted on the top of the cabinet for signal input and signal link output. The power rating of the NCS 215 B is 1.200W at 4 Ohms.

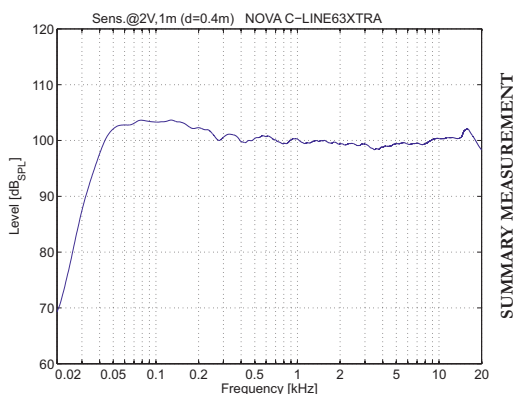

All measurements have been generated with FOUR AUDIO - WINMF / ROBO3 frontend. All measurements under free field conditions.



# CLINE63 XTRA



## 12 x 6,5'' + 4 x 15'' 3-Way Line-Array Front-System

### NCS L63F (flat version) and L63C (curved version) Line Array

Article number:	# 00620 (C-LINE 63 XTRA system) including subwoofer
System Type:	12 x 6" configuration (per cabinet)
Frequency Range:	70 Hz - 20 kHz
Coverage Pattern:	FLAT 90° x 36° / CURVED 90° x 36° nominal (HxV)
Crossover Modes:	Passive
Crossover Frequency:	1.25 kHz
Power Rating (Continuous / Program / Peak):	Passive: 2 x 720 W / 2 x 1.440 W / 2 x 2.880 W (per cabinet) Active LF: n/a Active HF: n/a
System Sensitivity (1w/1m):	106 dB SPL (per cabinet)
LF Driver:	6 x NOVA 6/100C (per cabinet)
LF Nominal Impedance:	5.4 ohms (per cabinet)
HF Driver:	3 x NOVA C1000, 1.75 in. voice coil comp. driver (p. cabinet)
HF Nominal Impedance:	5.4 ohms (per cabinet)
Active Tunings:	n/a
Enclosure:	NOVA ProWo© MDF, 16 mm
Suspension / Mounting:	n/a
Finish:	Black NOVA PolyCoat© finish
Grille:	n/a
Dimensions (W x H x D):	546 mm x 530 mm x 365 mm (per cabinet)
Net Weight:	35 kg (each)
Optional Accessories:	# 00507: NCS-S Stacking Adapter (4 pcs. needed)

IEC filtered noise with 6 dB crest factor. / Calculated based on power rating and sensitivity.  
CRAAFT AUDIO GmbH continually engages in research related to product improvement. Materials, design and sound tuning are introduced on existing products. Any current product of CRAAFT AUDIO GmbH may differ in some respect from its published description. CRAAFT AUDIO GmbH will always equal or exceed to original design unless otherwise noted. Limited liability on contents. Subjects to change without prior notice.

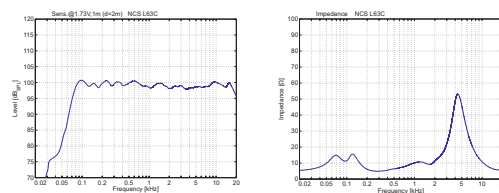

CURVED VERSION

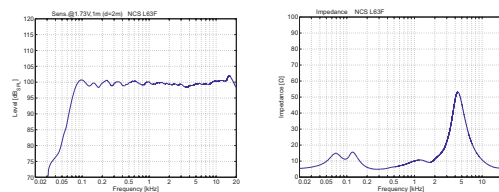

FLAT VERSION

### NCS 215B Subwoofer

Article number:	# 00620 (C-LINE 63 XTRA system) incl. line array cabinet(s)
System Type:	2 x 15" configuration
Frequency Range:	44 Hz - 1.2 kHz
Coverage Pattern:	n/a
Crossover Modes:	Passive
Crossover Frequency:	70 - 120 Hz (recommended)
Power Rating (Continuous / Program / Peak):	Passive: 600 W / 1.200 W / 2.400 W Active LF: n/a Active HF: n/a
System Sensitivity (1w/1m):	100 dB SPL
LF Driver:	1 x NOVA 15/600C
LF Nominal Impedance:	8 ohms
HF Driver:	n/a
HF Nominal Impedance:	n/a
Active Tunings:	70 - 120 Hz (recommended)
Enclosure:	NOVA ProWo© MDF, 16 mm
Suspension / Mounting:	n/a
Finish:	Black NOVA PolyCoat© finish
Grille:	n/a
Dimensions (W x H x D):	680 mm x 500 mm x 450 mm
Net Weight:	30 kg (each)
Optional Accessories:	# 00507: NCS-S Stacking Adapter

IEC filtered noise with 6 dB crest factor. / Calculated based on power rating and sensitivity.  
CRAAFT AUDIO GmbH continually engages in research related to product improvement. Materials, design and sound tuning are introduced on existing products. Any current product of CRAAFT AUDIO GmbH may differ in some respect from its published description. CRAAFT AUDIO GmbH will always equal or exceed to original design unless otherwise noted. Limited liability on contents. Subjects to change without prior notice.

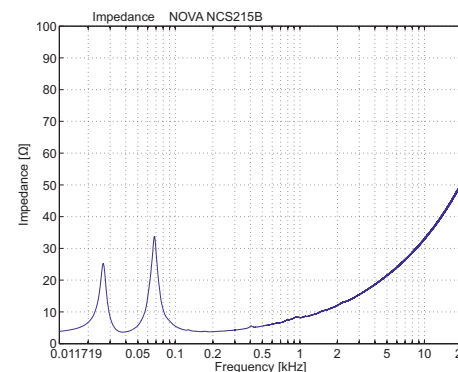
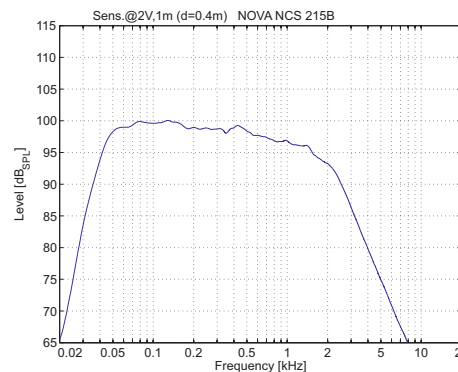

All measurements have been generated with FOUR AUDIO - WINMF / ROBO3 frontend.  
All measurements under free field conditions.

